

End profile for commercial use

Description:

- Specially developed for commercial use and high footfall areas
- Durable surface
- UV protected colour
- Installation possible with long or short side up



Characteristics:

Properties	Value
Material	Anodised Aluminium
Surface	Scratch resistant
Colours	Silver. UV protected

Demographics:

Product	Length mm	Width mm	Height mm	Quantity/pack pcs
End profile PGENPC	2700	17 (top side) 40 (bottom side)	1,5*	20

Installation instruction:

Flexible installation: Mount with short side up or with long side up.

Suitable for floors between 9 – 10 mm.

Add construction glue on the vertical side of the profile facing the wall or equivalent.

Ensure there is enough space between the flooring panel and the wall by using a spacer during installation. The spacer is later removed, and the profile pushed into place leaving an expansion gap.

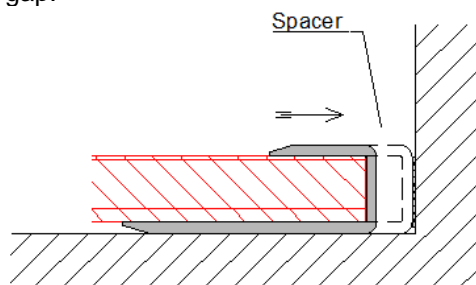

49181

